



FRIENDS OF LESOTHO

METSOALLE ea LESOTHO

President's Message

Lumelang Metsoalle,

There is always the danger your eyes will glaze over while reading the President's Letter, and that might be particularly true of this edition. However, if you are a PCV or RPCV who used FOL funds through the Volunteer Advisory Committee (VAC) or the Tuition Assistance Program (TAP), you might be interested in some recent changes. One of the main missions that Friends of Lesotho tries to fulfill is the support of PCV projects and tuition for Basotho school children. The logistics of transferring money to Lesotho has given us more headaches than any other aspect of that support. FOL has been busy finding a solution to that problem for the past couple of months.

When FOL began funding TAP and VAC, Peace Corps had bank accounts to which FOL either sent checks or wired money. The TAP and VAC committee chairpersons wrote checks from those accounts for scholarships and projects. About five years ago, Peace Corps informed FOL that new PC regulations prohibited volunteers and staff from handling checks and managing the bank accounts. When 'Me Thembi retired, she took over those responsibilities. Eventually the duties passed to Craig Anderson, an RPCV who worked at the U.S. Embassy. Craig recently transferred to another country, so FOL was again looking for someone to handle check writing.

The solution to this problem has been to form a relationship with the Peace Corps Partnership Program, which will make it easier and less expensive for FOL to support PCV projects. PCPP has a Lesotho Country Fund that can be used to fund smaller PCV projects similar to those funded through the VAC. PCVs will still submit project proposals to VAC and PC Staff for approval. Once

approval is granted, the Country Director can use the PCPP Country Fund to provide funds for the project. FOL will begin sending money to the PCPP Country Fund to support those projects.

The PC Lesotho TAP committee will also begin making changes to the Tuition Assistance Program, and FOL will fund that program through PCPP. FOL will begin reviewing larger project proposals submitted to PCPP by PCVs and helping to fund some of those projects. We will also continue to independently fund projects that do not involve PCVs.

The relationship between PCPP and FOL has some advantages. It eliminates wire-transfer fees and bank commissions. It also eliminates the need to find someone to manage the bank account in Lesotho. The greatest advantage is that PCPP is able to provide us with greater detail about the projects that FOL supports and more reliable reporting after a project is finished.



At the beginning of September, Friends of Lesotho received very sad news. PCV Thomas Maresco was killed in a robbery attempt in Maseru. Friends of Lesotho is deeply saddened to hear of Tom's passing, and we want to express our condolences to his family and friends and the Peace Corps Community in Lesotho. Tom wrote about his Peace Corps service in his blog. It was clear he loved being a volunteer and was making a difference in his village near Katse Dam. FOL will be looking at how we can contribute to a memorial in Tom's name.



Ka Khotso,
Richard Rowan
FOL President

Third Quarter 2010
Newsletter



Photo courtesy:
Andrew Dernovsek
RPCV, 2007-2009

Inside this issue:

<i>President's Letter</i>	1
<i>Laptops to Lesotho</i>	2
<i>Thomas Maresco</i>	4
<i>In Remembrance of Leland G. Jinks</i>	5
<i>Images of Lesotho</i>	5
<i>Fundraising Committee News</i>	6
<i>Peace Corps 50th Anniversary</i>	7
<i>Membership Committee</i>	7
<i>Treasurer's Report</i>	8
<i>Bits & Pieces</i>	9
<i>FOL Marketplace</i>	10
<i>Lifetime Membership</i>	11



METSOALLE ea LESOTHO

Laptops to Lesotho, an FOL-funded Project: Chapter One

Janissa Balcomb,
President & Co-founder
RPCV Lesotho 1977-1980

www.laptopstolesotho.org



History

It all started so innocently. A few years ago, my father and I each bought a \$200 computer, called an XO laptop, from the One Laptop Per Child “Give One, Get One” program. I liked the idea of giving a laptop to a child in a developing country, but I was also curious about what made these computers so special.

The XO laptops we received were perfect for kids, but, not being kids, we didn’t get much out of them, and soon they were collecting dust. In mid-2009, I decided it was time to give them to someone who could really appreciate them, so I contacted PC/L about donating them to a school.

Long story short, a primary school in Ketane received them, fell in love with them, and asked how to get more. One

thing led to another, and before I knew it, I found myself as president of a 501(c)(3) nonprofit organization with a staff of 11 dedicated volunteers in the U.S., South Africa, and Lesotho. One year later, here I am, planning a trip to Lesotho in November with about 50 laptops and a heart filled with hopes for the children of Ketane. Talk about a whirlwind!

Why Laptops?

When I first tell people about this project, I can see their skepticism...Laptops? Really? Why laptops? Computers are expensive, and, well, aren’t they a bit of a luxury for a poor nation? Isn’t there a better way to use the money? What about books, pens and pencils, paper, desks, classrooms, tuition?

Yes, I answer, all those things you list are important, but they do *absolutely no good* if there aren’t good teachers, if a child can’t attend school, or if a child loses interest because the lessons are boring. A laptop is pencil and paper, desk, classroom, teacher, and an entire library *full* of books all wrapped into one. And yet they are also so much more...an endless supply of time, information, one-on-one interaction, and reinforcement.

Not to mention that XO’s are really fun, entertaining, and cute. Even in the U.S., where children are jaded by technology, kids will cross a room to check out these

cool little laptops. I was working on an XO in the park one day, and I was swarmed by kids. Then, when they saw all the things they could do with an XO, they got *really* excited.

What Makes XO’s Special

XO’s are water-, dust-, and drop-resistant, i.e. virtually kid proof. They have an internal camera, microphone, speakers, and a screen visible in bright sun. They have low power needs and contain no hazardous materials. Each has internal networks that automatically connect to other XO’s, and they are wi-fi capable. They come with dozens of “activities” designed to teach kids while they are having fun. There are also other activities and curriculum resources available for them, designed by groups in South Africa and Lesotho, with a distinctly African feel.

Child Ownership

I suppose I should mention here that most of these laptops won’t be given to the school in Ketane. They will be given to the children. Individual ownership, one-on-one, children free to take *their* laptop home and use it in their spare time, free to explore it at their own speed, free to read books at home, to follow their interests, to play with it, to become comfortable and familiar with it, to take pride in it ...

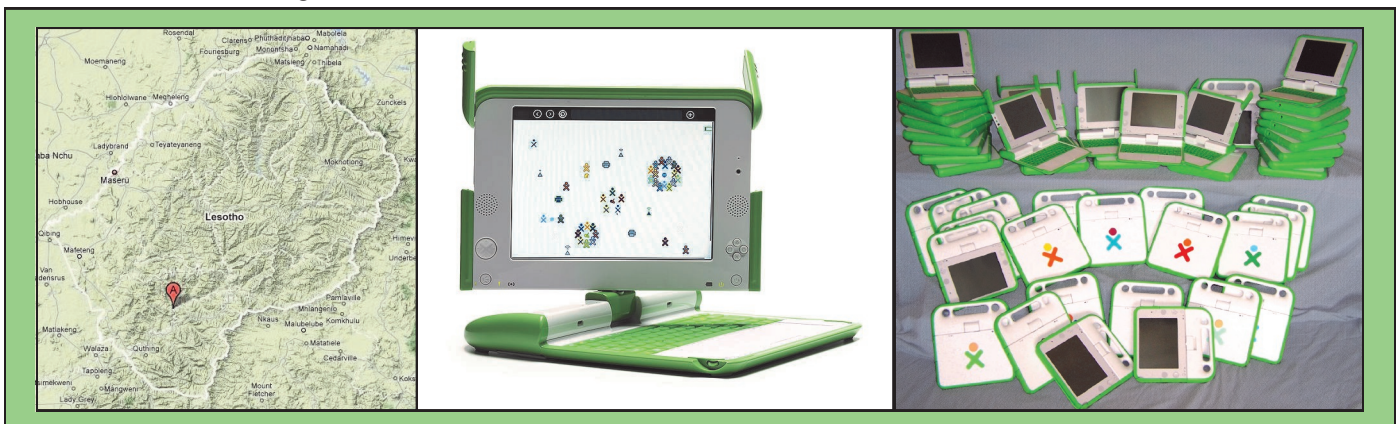



Laptops to Lesotho, an FOL-funded Project: Chapter One (continued)

(Continued from page 2)

Children will hold the power in their hands to change their own future. Decades of classroom education with books, paper, and pencil have repeatedly failed the children of Ketane. It's time to look at the problem from a different angle and try something new.

The people of Ketane understand this, and they see the great potential of these computers. A telling example: the parents encouraged their children to go to school for extra computer classes *during the harvest* when their help is needed in the fields.

That, I say, is "why laptops."

Community-based, Community Run

A second, major component of our project is grassroots community support and organization. Since its inception, this has been a community project. They requested it, and they've supported it with their time, labor, materials, and enthusiasm. The staff from two primary schools are in charge of on-the-ground operations. Those of us in the U.S. are merely facilitators for them, getting things started, and mentoring and training them, with the hope that one day soon we will be able to hand the entire

organization over to them, and through them to the community of Ketane, to run completely on their own.

The Future

Once we get the program established at the primary school, we hope to provide laptops to orphans, herdboys, and other disenfranchised children unable to attend school. There are also all kinds of spinoff possibilities: dissemination of HIV/AIDS information; peer counselors available for online chats that encourage safe, responsible behavior; remote access to the local clinic for video health consultations; small student-run entrepreneurial projects; and technical skills training using the electrical system, solar power, and information technology hardware.

Program Costs

Remember those kids in the park? When they found out how *cheap* an XO is, they wanted to buy one for themselves *with their own money*. Our program cost is miniscule compared to the benefit. About \$300-350 per child covers a laptop, shipping, solar power, and internet service. Over the average lifespan of a laptop, that's about \$50-60 per year, an amount that some people pay *per month* for internet, and chump change to many American kids. That *small* amount can give a high-quality education to a Mosotho child.

FOL's Contribution

FOL's support in our earlier stages of development has helped convince others our cause is worth supporting. We are now partnered with three other organizations, and, with FOL's generous contribution of \$1,436, we have surpassed \$10,000 in cash donations, pledges, grants, and donated supplies. Thank you, FOL!



Online donations can be made at
www.justgive.org

Donation checks, payable to
Laptops to Lesotho Inc.,
can be sent to:

Andrew Dernovsek, Treasurer,
Laptops to Lesotho Inc.
2200 S. University Blvd #511
Denver, CO 80210

Photos courtesy Andrew Dernovsek and Janissa Balcomb





METSOALLE ea LESOTHO



(Excerpt from <http://www.peacecorps.gov> press release.)

WASHINGTON, D.C., Sept. 4, 2010 – Peace Corps Director Aaron S. Williams is saddened to announce the death of Peace Corps volunteer Thomas “Tom” Maresco in Lesotho. Tom, 24, died as a result of a gunshot wound on Sept. 3 in Maseru, the capital of Lesotho. The investigation into this incident is ongoing, but at this time it appears it may have been an attempted robbery.

"Tom was an exceptional volunteer, leader, teacher and coach – he was an integral part of his host community where he shared his passion for teaching, music and sports," said Director Williams. "We are deeply saddened by this tragic event, and I ask that you keep Tom's family and our volunteers and staff in Lesotho in your thoughts and prayers."

Tom, of Port St. Lucie, Fla., was a secondary education teacher in the village of Katse in the highlands district of Thaba-Tseka. He arrived in Lesotho for Peace Corps service in November 2009. A graduate of the University of Florida, Tom served as a science teacher in Lesotho. He was an active member of his local community in Katse and coached youth in a number of sports including basketball and swimming. Tom became his district's representative on the Peace Corps Lesotho HIV/AIDS committee and was committed to developing innovative ways to address HIV awareness and prevention among young people. He was scheduled to complete his Peace Corps service in January 2012.

.....
Friends of Lesotho sends its heartfelt condolences to Tom's family. We all grieve with them during these difficult times. A funeral Mass and burial service for Thomas Carmine Maresco, Jr., was held on September 16 in Port St. Lucie, Florida. In lieu of flowers, the family requests donations be made at any PNC bank branch to the Thomas C. Maresco Jr. Memorial Medical Scholarship Fund at Indian River State College.

Photos from Thomas Maresco's blog





Images of Lesotho

Photo credits:

Top left and center left by Nicole Potsane

All other photos by Joseph M. Thompson

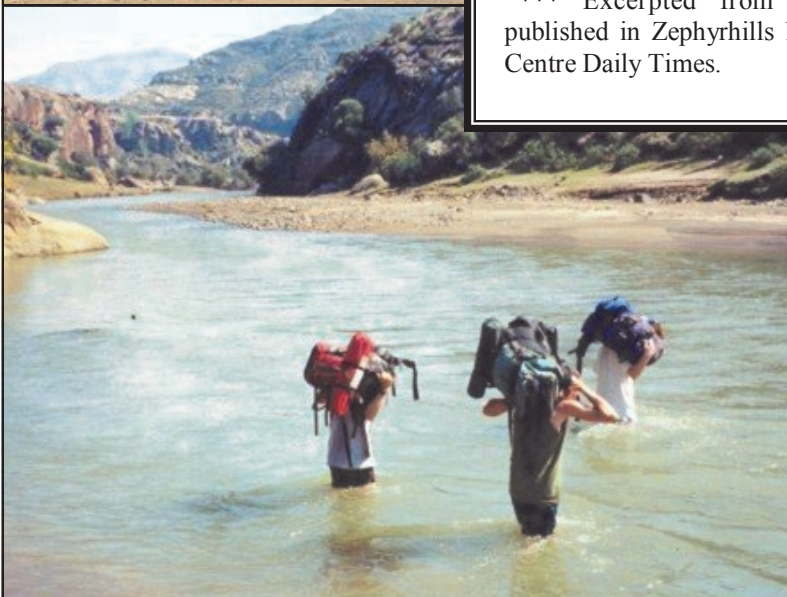
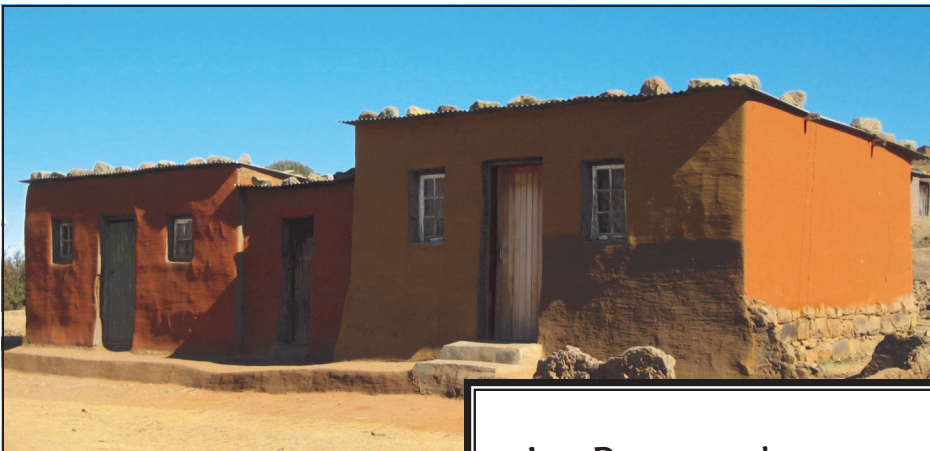

In Remembrance

Leland G. Jinks, February 9, 1925 – April 5, 2010, whose career in agricultural sciences took him from County Extension Agent to Associate Director for the Peace Corps in Lesotho, passed away at Florida Hospital Zephyrhills, Florida. Mr. Jinks had a long and distinguished career in the field of agriculture with an emphasis on dairy, poultry, horticulture and youth education. In 1970 he undertook a three-year post with the Peace Corps as Associate Director in Lesotho, working to establish programs in forestry, fisheries, renewable energy and clean water, and initiating the introduction of strawberries as a cash crop.

*** Excerpted from an obituary published in Zephyrhills News and the Centre Daily Times.

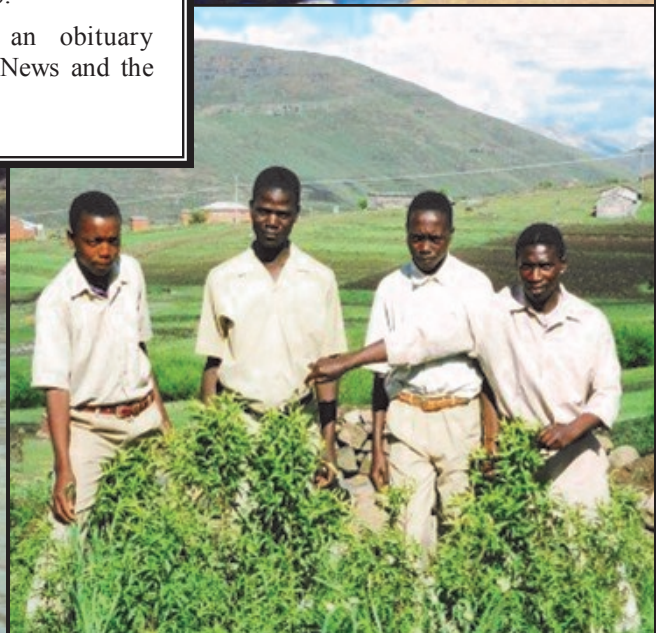



METSOALLE ea LESOTHO

Fundraising Committee News

A New Way to Donate

Friends can now donate to FOL on line at razoo. Razoo describes itself as “a social network for social good” that aims to promote sustainable human development.” They’ve established an easy way to give online to non-profit causes. To make a contribution to FOL, simply go to <http://www.razoo.com/story/Friends-Of-Lesotho>. Enter the amount you wish to give and click on Donate. You’ll be asked for credit card details (the site is secure and protects donor information), then enter the info, click on Donate Now, and you’re done. The full amount you contribute comes to Friends of Lesotho. Razoo pays transaction fees.

Contribute While You Search and Shop

Two other ways to direct money to FOL are to use **GoodSearch** as your Internet search engine and make online purchases through **GoodShop**. FOL is now listed with both.

Goodsearch has developed a way to direct a portion of Internet advertising fees to charities that searchers choose. So, when you click on a paid link during a search, part of advertiser dollars (not your own) get passed along to the organization you choose to support (e.g., FOL). Goodsearch.com is powered by Yahoo’s search engine.

When you shop through **GoodShop** at one of the site’s retail partners, GoodSearch receives a commission, which it directs to the non-profit charity of your choice. The amount donated is different for each retailer, but it averages approximately 3% of the total sale (the percentage is indicated below the merchant’s logo).

The easiest way to access both these sites on a regular basis is to download a GoodSearch toolbar for your browser. The toolbar features links to both GoodSearch and GoodShop. You’ll find it at <http://www.goodsearch.com/toolbar/mode/>. Otherwise, just go to goodsearch.com. Enter Friends of Lesotho in the box titled “Who do you GoodSearch for?” and click on Verify. Then begin your search. GoodShop works the same way.

Join FOL on Facebook

Friends of Lesotho now has a cause site on Facebook, but we need members. To join the cause, go to http://www.causes.com/causes/505986?m=9e4cc0c7&recruiter_id=99040922. Click on Join Cause. You’ll be asked to login to Facebook first, or to sign up if you don’t have an account. You needn’t donate to join the FOL cause, but you can if you like. The main thing now is to boost our cause member numbers.

New Fundraising Chair

Peter Neumann has generously volunteered to become chair of FOL’s fundraising committee. Peter and his wife, Maria, were Peace Corps Volunteers in Mohale’s Hoek, 2004-06. Bill Moore has resigned from the chair, concerned that he would be unable to fulfill the position’s duties. He is accompanying his wife, Mary Wagner, to Lusaka, Zambia, where she will teach as a Fullbright Scholar at the University of Zambia and work with the Lubutu Library Project. We thank him for his volunteer efforts on this committee!!



www.friendsoflesotho.org

You can now PAY your dues and make donations with a

CREDIT CARD

1234 5678 9012 3456

*Making a difference
at the grassroots level*

Photo credits:

Right by Andrew Dernovsek - installing a solar panel at the computer school in Ketane.

Left by Nicole Potsane



50th Anniversary of Peace Corps & Lesotho Reception September 21-25, 2011 Washington, DC

Lumelang Bana B'eso,

In May 2010, the Lesotho I (1967-69) group had its first reunion in 40 years. We had a great time reminiscing, updating each other on our life chapters, and hearing presentations from Aaron Williams, the Peace Director; Kevin Quigley, President of the National Peace Corps Association, Fernando Moyle from the Peace Corps Lesotho Desk; and John Hollister from Friends of Lesotho.

Some outcomes from our pitso on the last day of our reunion included contacting Friends of Lesotho to mobilize for the 50th Anniversary Celebration in 2011. We hope that we can achieve a goal of engaging 25% of the approximately 2800 volunteers and staff who have served in Lesotho in the celebration and outside activities.

Because of the success of the Lesotho I reunion, I have been recruited/volunteered to help orchestrate our celebration for 2011.

To try to get as many of us together in one place in **2011**, we want to find out:

1. Would you come? This includes family/friends.
2. **Would you like to help** us plan the reception for Lesotho volunteers, staff, families, and friends on September 24, 2011?

Please respond by October 15, to Wc44reed@aol.com and indicate what years you served in Lesotho.

Feel free to pass this information to other colleagues who served with you.

We will keep you posted as we gather information from all of us.

Khotso, pula, nala,

 Bill Reed
Lesotho I (1967-69)

Membership Committee News

Tricia Smallwood of Sayville, NY, and Hazel Domangue of Chicago, IL, were welcomed as new regular members during this past quarter.

Christopher Conz of Santa Monica, CA and Merrill Nosler of Folsom, CA joined FOL under our one-year complimentary membership offer following their recent COS. PCV Kristine Movalli, who is serving in Mokhotlong until 2011, also joined FOL under our complimentary membership program.

Lifetime Membership Impact

Thank you Susan Bruckner and Brent Schaeffer for converting your regular memberships into Lifetime Memberships.

At the current rate of exchange, a basic \$250 Lifetime Membership equals 1,800 rand. The following is an example of the potential impact Lifetime Memberships can have to support projects in Lesotho. Two Lifetime Memberships can cover the monthly cost of providing two meals a day to the 45 orphan preschoolers being cared for at the Little Angels Day Care and Pre-school program in Thabo Bosiu. That is 90 meals each day times 30 days, or 2,700 meals a month.

But, as they say, a picture is worth a thousand words.



Some of the Little Angels in action.

Little Angels has received financial support from a private foundation--support which will be running out at the end of 2010. During the last couple of years FOL has provided support to several small projects at Little Angels as part of Prof. Scott Rosenberg's annual student volunteer trips to Lesotho. Thanks to contacts made by Scott, Donations Committee Chair, FOL will be collaborating with BloomAfrica and his local Rotary Club in Ohio to help fund the 2011 food and operating costs at Little Angels. The Little Angels Day Care and Pre-school project was initiated by RPCV Rose Paradise, whose PC service started in 2003. Rose stayed in Lesotho and has worked closely with locals to provide the basic necessities for these orphans.

Thanks to the generosity of FOL's donors and regular and lifetime members, these little angels will have a chance to learn and be well fed for another year.





METSOALLE ea LESOTHO

Bits & Pieces



Sign up for FOL Online Store News

Did you know that you can sign up to receive updates from the FOL Online Store? Just go to the store home page, www.cafepress.com/lesotho, enter your email address in the box at the bottom of the "Store Newsletter" section, and click <Subscribe>. We promise not to fill your inbox with a lot of junk. We will send out store newsletters no more than three or four times a year, and only to announce new items or product lines, or when there are great deals available in the store.

Go directly to
www.cafepress.com/lesotho

You can help FOL earn up to 10% extra from CafePress by going *directly* to the FOL store rather than getting there via the CafePress home page. So remember to add "/lesotho" to the website address to do your shopping!

Friends of Lesotho - 2010 Treasurer's Summary for Board:

July 18, 2010

	5/17/2010	7/18/2010	Difference
Current Bank Balance (checking):	\$22,470.50	\$25,252.87	\$2,782.37
Current Bank Balance (savings):	\$44,253.07	\$44,323.05	\$69.98
Total (both accounts)	\$66,723.57	\$69,575.92	\$2,852.35
<i>Interest Earned CY to Date (incl. above)</i>	\$125.84	\$195.82	\$69.98
Paid Membership (Incl. Adv Dues - 16 for 2010):	53	75	22
New members this Year to date:	2	4	2
Non-member cash donors Year to date:	19	24	5

2010 Extra Donation Fund Status:

Donation Fund	Amount in Fund	Amount sent to Lesotho*	Amount Pending Future Disbursement
Undesignated Fund (\$250 min balance)	\$11,547.88	\$1,749.95	\$9,797.93
Tuition Assistance Program (TAP) Fund	\$24,905.24	\$0.75	\$24,904.49
HIV/AIDS Fund	\$601.32	\$0.00	\$601.32
Morija Museum Fund	\$0.00	\$0.00	\$0.00
Orphanages Fund	\$1,546.54	\$0.00	\$1,546.54
Memorial Scholarship Fund	\$12,601.42	\$22.50	\$12,578.92
PCV Projects	\$329.19	\$0.00	\$329.19
Peka Classroom Completion (Thompson PCV)	\$2,700.00	\$2,700.00	\$0.00
Village Hope Project (PCV)	\$1,801.40	\$0.00	\$1,801.40
LCCU (Lesotho Child Counseling Unit)	\$1,000.00	\$1,000.00	\$0.00
Uraneck PCV Projects (Mountain Schools)	\$194.00	\$194.00	\$0.00
T. Veiga PCV Project (scholarship)	\$25.00	\$25.00	\$0.00
Lesotho I Reunion (Fundraiser event)	\$15,090.00	\$14,041.03	\$1,048.97
Totals	\$72,341.99	\$19,733.23	\$52,608.76
<i>Difference from Prior report:</i>	\$4,422.87	\$1,924.14	\$2,498.73

Note (*) - These include donation collection fees from Just Give and transfer fees in sending funds

2010 Operating Expense Status:

Current Cash in Accounts (as above):	\$69,575.92
Subtract out:	
Project Expenditure Obligations (per above, incl. interest)	-\$52,608.76 Incl. interest
Future Dues for Carryover	-\$45.10 Incl. interest
Life Membership Fund (incl. interest)	-\$8,310.82 35= total members
Cash Available for FOL Expenses =	\$8,611.24
Unused Expenses in 2010 Budget -	\$4,386.22
Current Cash Reserve =	\$4,225.02 excluding unspent budget
(Total operating cash expenses, incl. NPCA pass thru):	\$1,048.78
(Total operating inkind expenses to date):	\$63.59

If you have comments, questions, suggestions, news, articles, websites, photos, or other items to contribute to this newsletter, please contact:

Faye Farmer at f_e_@hotmail.com or 2612 E. Geneva Dr. Tempe, AZ 85282.

We reserve the right to edit submissions for clarity and length.

We would be happy to return submissions.



Bits & Pieces

Got Photos??

We would love to showcase your pictures of the people, places, and things of Lesotho and Peace Corps in our various publications, including this newsletter.

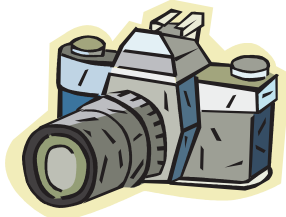

Please email your photos to Faye Farmer at f_e_@hotmail.com

**Check out the
new FOL website**

www.friendsoflesotho.org



Sign up for email-only delivery of your FOL newsletter and you'll help FOL send more money to Lesotho. Sign up at the membership page at www.friendsoflesotho.org

PLEASE PAY YOUR MEMBERSHIP DUES ANNUALLY

Your membership expiration date is located on the mailing label.



FOL Marketplace

Customized Peace Corps Lesotho Clothing Now Available

FOL sells a variety of clothing with the Peace Corps logo in our online store. Now you can get customized PC/L clothing with your name, service dates, location, or other customized text on it. There will be a \$1.00 fee added for this service. Go to www.cafepress.com/lesotho/3031772 to see the clothing options.

Email questions or customization requests to janissa@silverstar.com. Include the text you'd like added and any color/font preference. You will be allowed to preview the item(s) before placing an order, there is no commitment to buy, and we guarantee 100% satisfaction or your money back!

amazon.com
and you're done.™

Whenever you shop at Amazon.com, start at FOL first.

Friends of Lesotho is an Amazon.com affiliate.

Access Amazon.com from the FOL website and a portion of the price of your purchase will be donated to FOL by Amazon.com.

Go to the FOL website, click on the "Shop" tab, select "FOL Amazon," and click on the Amazon link.

<http://www.friendsoflesotho.org/shop/amazon/>





FOL Marketplace

SHOP TO HELP



FOL Online Store

www.cafepress.com/lesotho



Shop at Amazon.com



Use this link www.friendsoflesotho.org/shop/amazon to reach Amazon.com. A percentage of the purchase price of *anything and everything* you buy will be donated by Amazon.com to FOL. It costs you absolutely nothing.



FOL Special Stock



www.friendsoflesotho.org/shop/fundraising-items/
Bookmarks and luggage tags with one-of-a-kind artwork, and a music CD.



FRIENDS OF LESOTHO

4110 Denfeld Avenue
Kensington, MD 20895
(301) 942-2751
www.friendsoflesotho.org

Lifetime Membership Form

Thank you for considering Lifetime Membership Some of the Benefits of Lifetime Membership

- Knowledge that Lifetime Memberships are used to fund grassroots projects in Lesotho for many years (Our operating expenses come from ordinary annual dues and represent only 4% of those dues.)
- A Lifetime Membership Certificate suitable for framing will be sent to you.
- Recognition in the Annual Report, Website and Newsletter.
- Tax deductible charitable donation.
- Save FOL money in renewal postcards.
- Your example and level of commitment may encourage other RPCVs to choose Lifetime Membership.

*Name(s): _____

Address: _____

City: _____ State: _____ ZIP: _____

Phone: Home _____ Cell _____

*Email: _____

The FOL Newsletter is sent by e-mail to allow more money to be sent to projects in Lesotho. Please check if you prefer postal delivery.

*Yrs in Lesotho: _____ to _____: *District: _____

*Village: _____ CHED EDUC Other _____

Project(s): _____

Current Occupation/Employer: _____

The FOL Website Member Directory is accessible to members only by use of a secured ID and Password. The fields marked above with an * will be included in the website directory, unless you indicate otherwise. Do not include my contact information on the website.

Privacy Policy: FOL will not release member information to any organization, except to the National Peace Corps Association, upon implied request when a member joins both FOL and NPCA. FOL will share membership information with other FOL members and prospective PCVs seeking information about Lesotho.

Membership Options

(Per person)

Basic Lifetime—\$250

Bronze Member—\$500

Silver Member—\$750

Gold Member—\$1,000

Members _____ Total Due \$ _____

Installment payments of \$250/yr may be made for Bronze, Silver or Gold Club.

Please sign below as an indication of your commitment to pay future installments.

Date: _____

Signature _____

Mail your check and completed form to: Friends of Lesotho, 4110 Denfeld Ave., Kensington MD 20895, USA.

Or pay on-line by credit card with our website links to JustGive.org or Razoo.org. Click on Join/Renew at: www.friendsoflesotho.org and follow



Making a difference at the grassroots level



For FOL use only. Please do not complete the information below.

Check # _____ Amount \$ _____ Member Since _____ New _____

Source _____ No. of Members _____

01/01/2010



FRIENDS OF LESOTHO

4110 Denfeld Avenue
Kensington, MD 20895

301.942.2751
board2@friendsoflesotho.org



METSOALLE ea LESOTHO

Third Quarter 2010
Newsletter



FRIENDS OF LESOTHO

President: Richard Rowan (board2@friendsoflesotho.org)

Vice President: Dyann Van Dusen (board3@friendsoflesotho.org)

Treasurer: John Hollister (board4@friendsoflesotho.org)

Secretary: Kevin Freer (board1@friendsoflesotho.org)

Embassy Liaison: Scott Rosenberg (srosenberg@wittenberg.edu)

Board Members: Ronna Abbott (ronnaabbott@yahoo.com)
Dick Nystrom (dickpam@nystrom.us)

Additional assistance from the following members:

Graphic Artist/Fundraising: Janissa Balcomb

Finance & Audit: VACANCY
Looking for Finance & Audit Committee Volunteers

Website & Database: Bill Dunn
Martin Smith

Memorial Scholarships: Bill Reed

New PCV Contact: Elizabeth Perry (perry_41@hotmail.com)

Newsletter: Faye Farmer, Coordinator (f_e_@hotmail.com)
Nicole Potsane, Layout & Design
Allison Pranger, Copy Editor